

Notes

- For general notes & design notes refer to drawing 09-122-101.

Note:
Approximate location of culvert based on RGS report J4760/19/E/F dated 5th July 2019 and Lithos report 2895/1 dated December 2017

Key

- Denotes site boundary
- Denotes existing stone culvert to remain
- Denotes existing collapsed stone culvert to be removed during phase 2
- Denotes existing stone culvert to be removed during phase 2
- Denotes proposed phase 2 temporary diversion/phase 3 concrete pipe or box culvert to be installed
- Denotes existing stone culvert to be re-laid
- Denotes proposed surface water manhole/access point
- Denotes proposed brick surface water manhole/access point
- Denotes existing surface water manhole
- Extent of Root Protection Area (RPA). Works/excavation in this area to be minimised as much as practicable
- Extent of Root Protection Area (RPA). No additional works or excavation beyond those shown in the contract drawings to be undertaken without prior written approval from the Local Planning Authority (Kirklees Council)

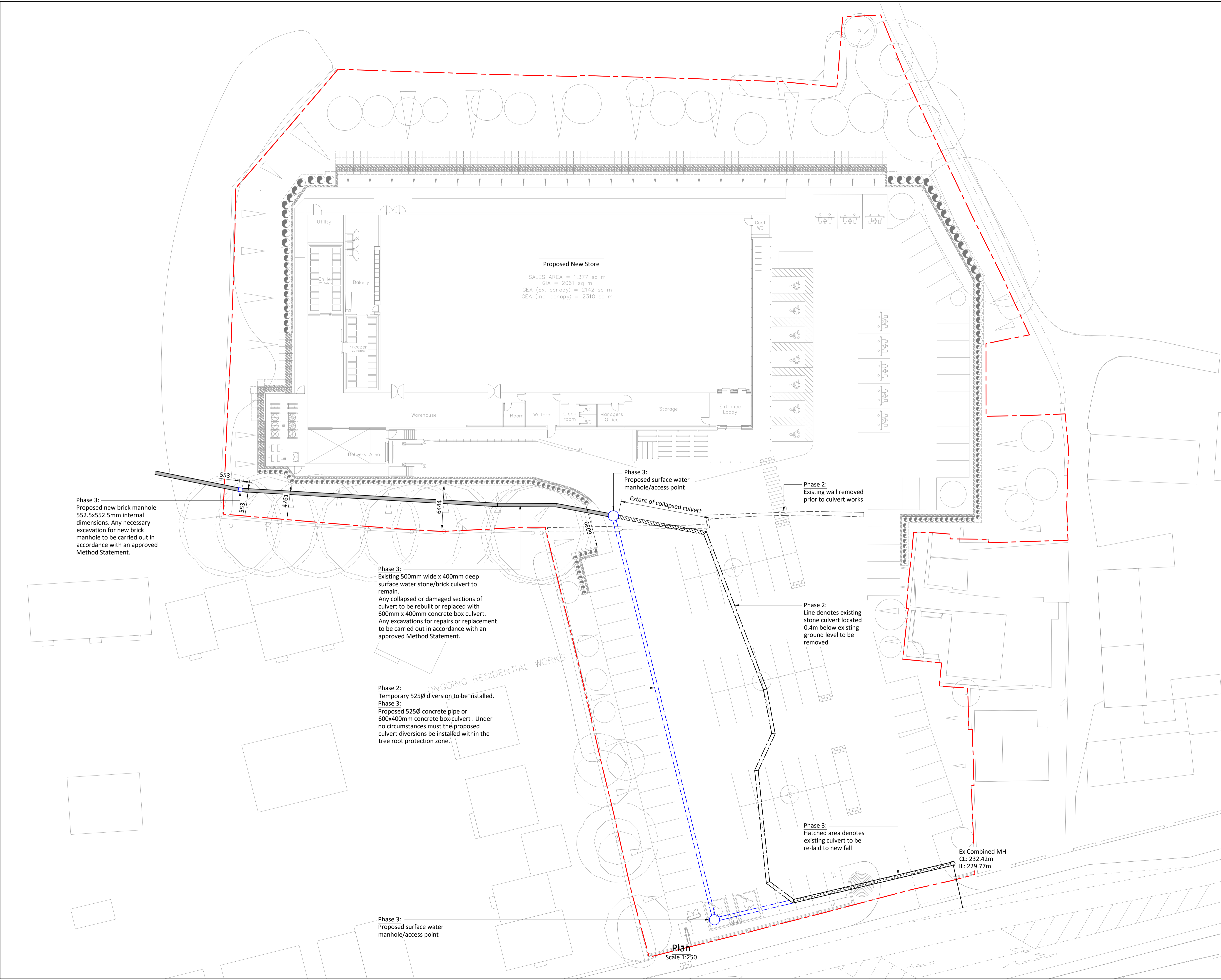

Site plan updated.	E	21/09/2020	TM	KGP
Notes Updated	D	13/07/2020	TM	KGP
Culvert diversion information added	C	13/01/2020	TM	KGP
Site plan updated.	B	18/12/2019	TM	KGP
Client name updated.	A	16/09/2019	TM	KGP
DESCRIPTION	REV	DATE	CHK	APR



Beam Consulting
 14 Bond Street
 Wakefield
 WF1 2QP
 Tel: 01924 361653
 Fax: 01924 364631

PROJECT
Lidl Store
New Hey Road, Huddersfield

DRAWING TITLE
Culvert Diversion
General Arrangement

CLIENT
Lidl Great Britain Ltd

STATUS
Information

DRAWN	KK	DATE	22/07/2019
CHECKED	TM	SCALE	
APPROVED	KGP	AS SHOWN @	A1
DRAWING NUMBER	09-122-502		REVISION
			E