

THIS DRAWING IS COPYRIGHT, AND REMAINS THE PROPERTY OF HTC ARCHITECTS. IT MUST NOT BE REPRODUCED, USED, DISCLOSED OR TRANSMITTED TO THIRD PARTIES IN ANY FORM, IN WHOLE OR IN PART, WITHOUT PRIOR WRITTEN PERMISSION.

DO NOT SCALE!
ALL DIMENSIONS SHOULD BE CHECKED ON SITE BEFORE WORK COMMENCES

TITLE PLAN: Y110619

IN LINE WITH SIGNIFY DRAWING 0400190954

ARBORICULTURAL SURVEY: 12484 SR Arboricultural Report of the former Spotted Cow, New Hey Road, Huddersfield

TRACKING: EISA 1814 07 Proposed Site Plan OPTION 5 paths update

IN LINE WITH MODIFIED 2018.1 SPECIFICATION

SURVEY INFORMATION:
D224-001 June 2018 Landform Surveys
001/002 November 2014 Landform Surveys

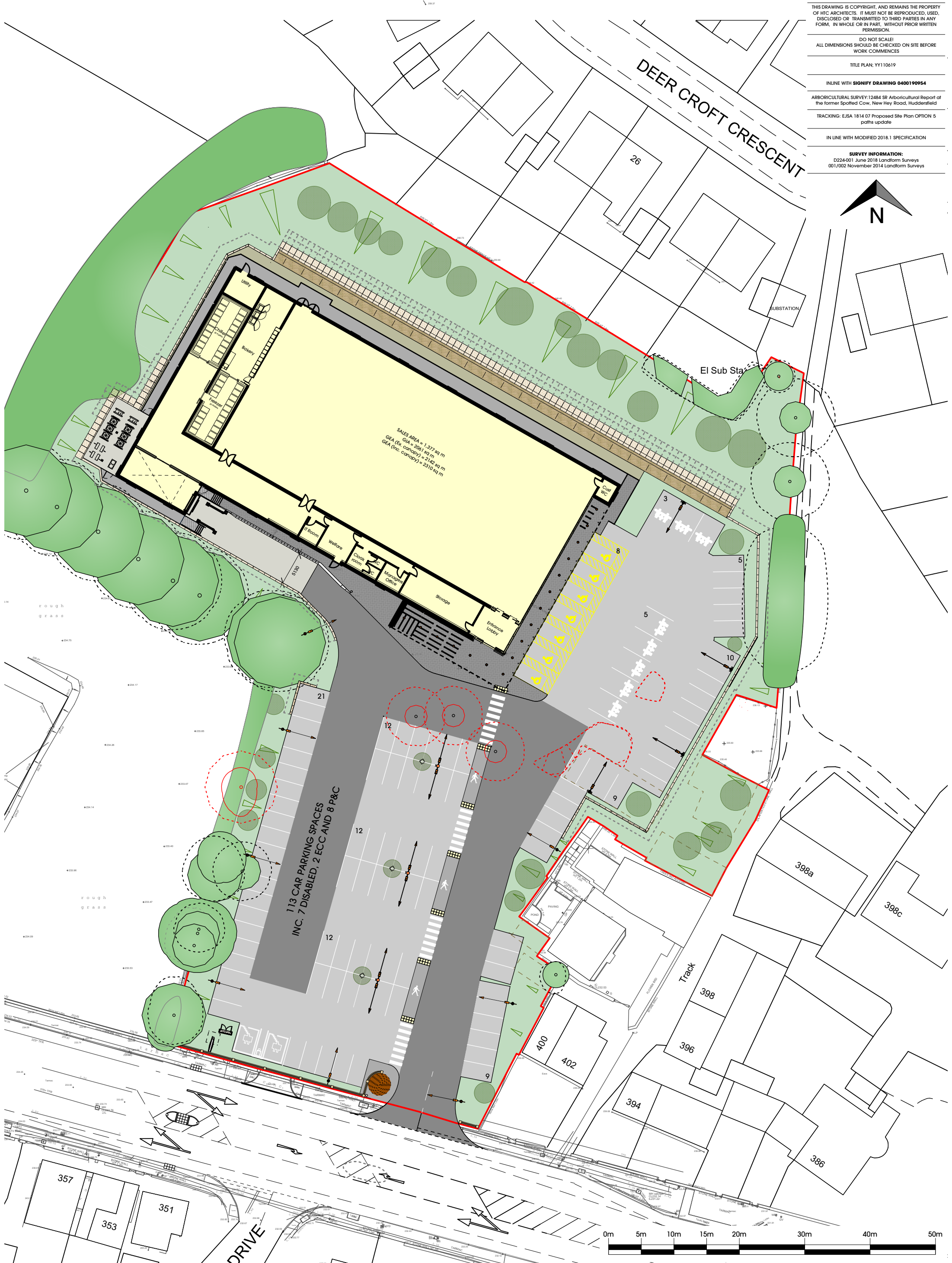

Rev	Date	Description	Drawn
G	04.09.20	Site Plan updated inline with P5411 Site Plan Overlay	M.P.
F	30.10.19	1. Additional steps to plant area 2. Plant area updated to update door access, new route via delivery bay and new route via back of store 3. Gravel at rear added 4. Update engineer drawing incorporated 5. ECC Station added 6. Sight Lines added 7. Roof Protection Area trees to delivery bay area considered, solutions incorporated to divert from Roof Protection Areas	LS
E	22.07.19	Pedestrian walkway bollards removed and plant updated	AB
D	10.07.19	Updated in line with dwg. SK09	JBH
C	20.06.19	Added bollards to pedestrian walkways in carpark, update to site boundary, added 1 parking space, updated annotations	JBH
B	05.06.19	Minor update	LS
A	28.05.19	Updated in line with P414	LS

client
Lidl GB Ltd



project
**New Hey Road,
Huddersfield**

drawing title
Proposed Lighting Plan

date April 2019

status Planning Issue

scale 1:500 @ A3

drawn RT checked LS

job no. 1814 dwg no. P413 rev. G

htcarchitects

York Place Studio
8 Britannia Street
Leeds
LS1 2DZ

T: (0113) 244 3457
W: www.htcarchitects.co.uk
E: info@htcarchitects.co.uk