

THIS DRAWING IS COPYRIGHT AND REMAINS THE PROPERTY OF HIC ARCHITECTS. IT MUST NOT BE REPRODUCED, USED, DISCLOSED OR TRANSMITTED TO THIRD PARTIES IN ANY FORM, IN WHOLE OR IN PART, WITHOUT PRIOR WRITTEN PERMISSION.

DO NOT SCALE!
ALL DIMENSIONS SHOULD BE CHECKED ON SITE BEFORE WORK COMMENCES

BOUNDARY BASED ON TITLE DEEDS: WYK696805

BOUNDARY BASED ON TOPOGRAPHICAL SURVEY: 5328-0721-01C

HIGHWAYS BASED ON DRAWING: 21-209-TR-005 Site Access Arrangement Rev C

SUBJECT TO LEVELS STRATEGY REVIEW

LIDL INTERNALS ARE SUBJECT TO CONFIRMATION FROM LIDL FOLLOWING LATEST SPECIFICATION IMPLEMENTATION (AUG 2023)

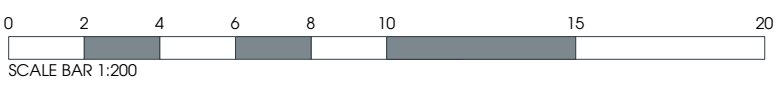
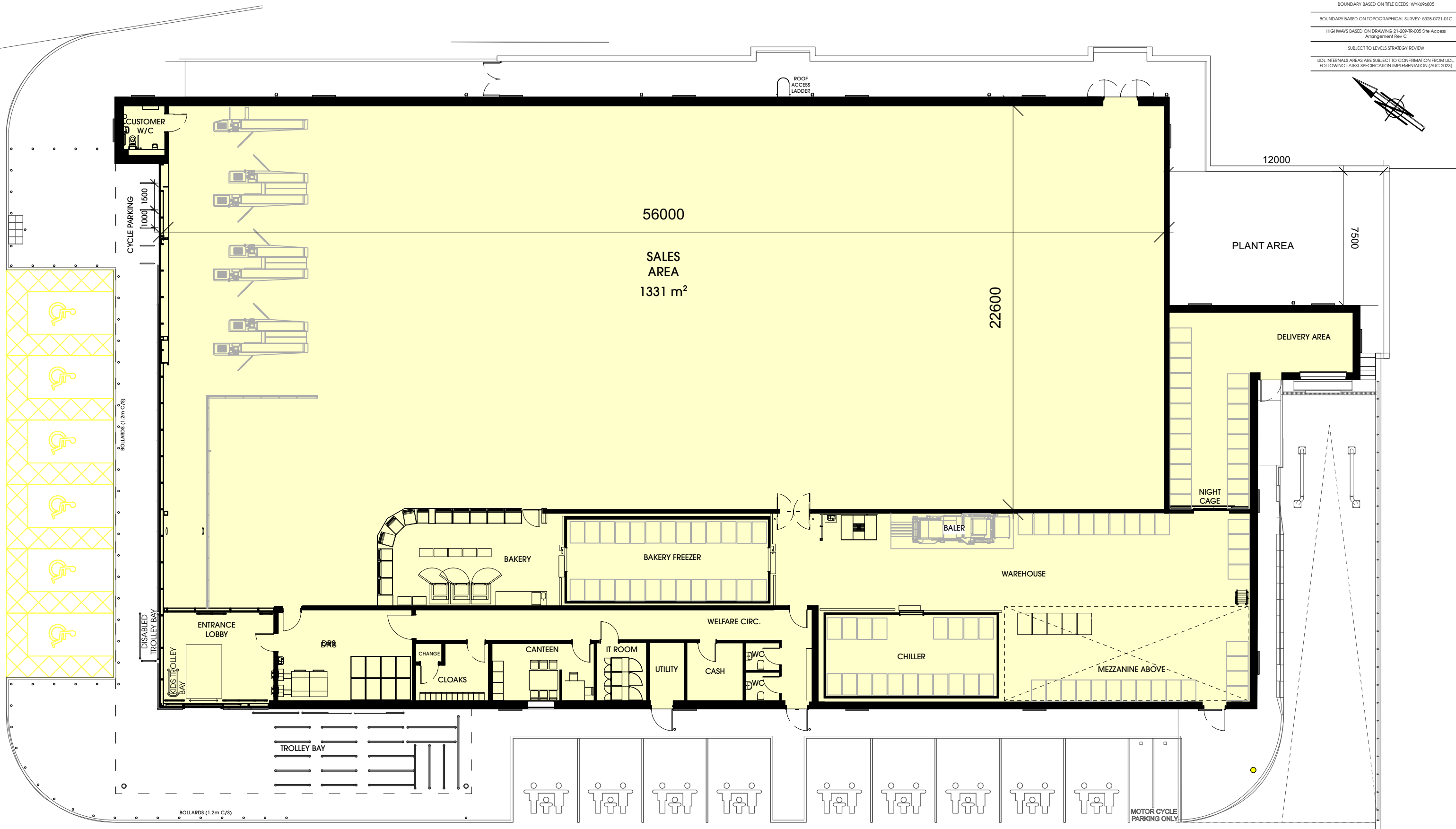
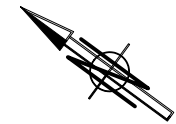

htcarchitects

client
Lidl GB Ltd.

project
Blackmoorfoot Road
Huddersfield

date August 2023
status Planning
scale 1:200 @ A3
drawn KA checked BM
job no. 2783 dwg no. P110 rev. B

Rev.	Date	Description	Drawn
A	27/10/2023	Childrens trolley bay added	BM
B	28/03/2024	Proposed signage removed Bollards added, Disabled trolley bay and	KA

York Place Studio
8 Britannia Street
Leeds
LS1 2JZ
T: (0113) 244 3457
W: www.htcarchitects.co.uk
E: info@htcarchitects.co.uk

