

THIS DRAWING IS COPYRIGHT AND REMAINS THE PROPERTY OF HTC ARCHITECTS. IT MUST NOT BE REPRODUCED, USED, DISCLOSED OR TRANSMITTED TO THIRD PARTIES IN ANY FORM, IN WHOLE OR IN PART, WITHOUT PRIOR WRITTEN PERMISSION.

DO NOT SCALE!
ALL DIMENSIONS SHOULD BE CHECKED ON SITE BEFORE WORK COMMENCES

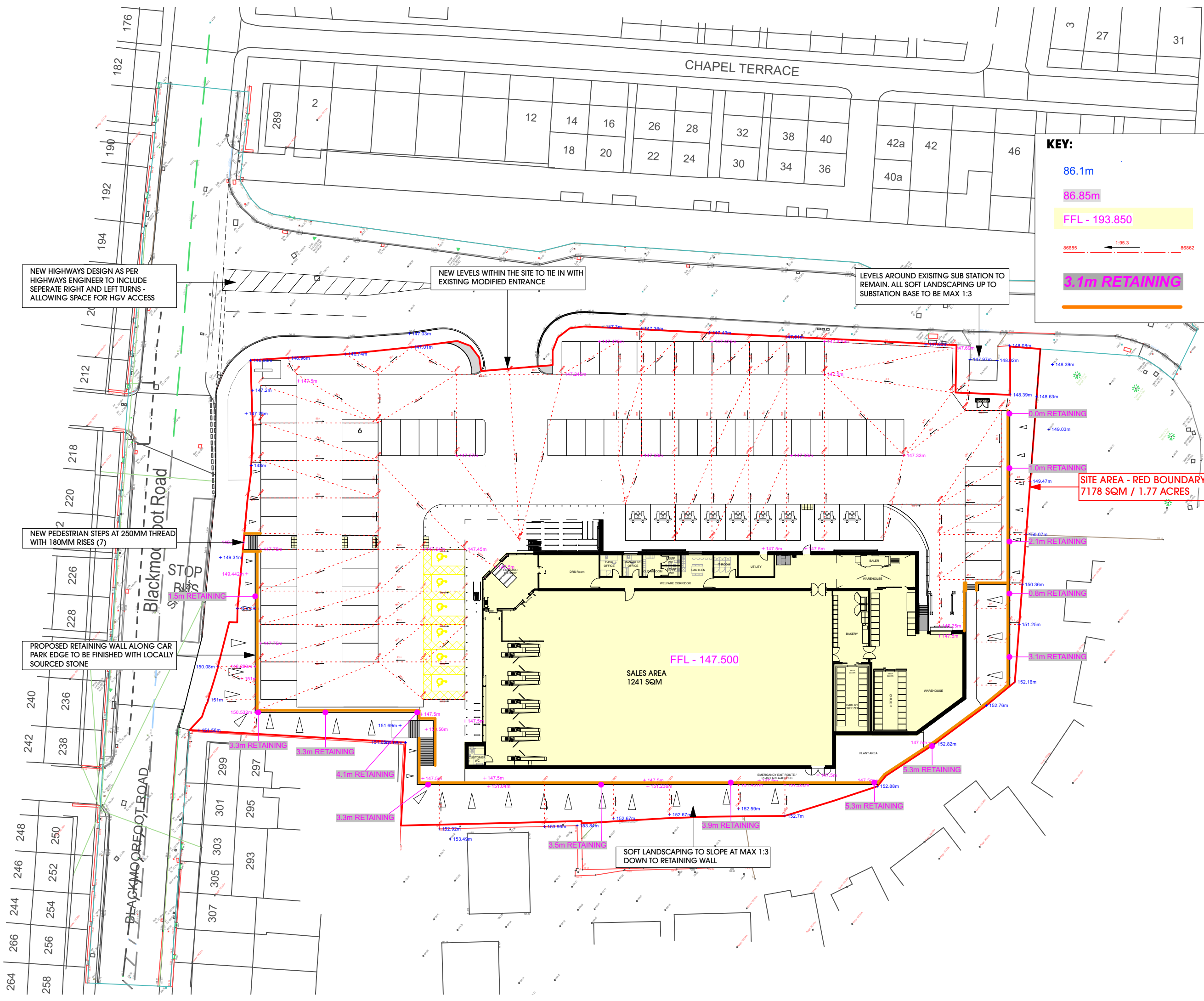

KEY:

- 86.1m EXISTING EXTERNAL LEVEL
- 86.85m PROPOSED EXTERNAL LEVEL
- FFL - 193.850 PROPOSED FLOOR LEVEL
- 86685 1.95.3 86862 DIRECTION OF FALL - INCLUDING FALL ANGLE SET AT 1:X - OUTSIDE DIMENSIONS INDICATE THE LEVELS
- 3.1m RETAINING PROPOSED RETAINING WALL HEIGHT INDICATOR - AVERAGE HEIGHT IN LOCATION NOTED FROM EXISTING GROUND LEVEL
- PROPOSED RETAINING WALL

NEW HIGHWAYS DESIGN AS PER HIGHWAYS ENGINEER TO INCLUDE SEPARATE RIGHT AND LEFT TURNS - ALLOWING SPACE FOR HGV ACCESS

NEW LEVELS WITHIN THE SITE TO TIE IN WITH EXISTING MODIFIED ENTRANCE

LEVELS AROUND EXISTING SUB STATION TO REMAIN. ALL SOFT LANDSCAPING UP TO SUBSTATION BASE TO BE MAX 1:3

NEW PEDESTRIAN STEPS AT 250MM THREAD WITH 180MM RISES (7)

PROPOSED RETAINING WALL ALONG CAR PARK EDGE TO BE FINISHED WITH LOCALLY SOURCED STONE

SOFT LANDSCAPING TO SLOPE AT MAX 1:3 DOWN TO RETAINING WALL

Rev	Date	Description	Drawn

htcarchitects

York Place Studio
8 Britannia Street
Leeds
LS1 2DZ
T:(0113) 244 3457

W: www.htcarchitects.co.uk
E: info@htcarchitects.co.uk

client
Lidl GB Ltd. 

project
Blackmoorfoot Road
Huddersfield

drawing title
Proposed Levels Strategy

date August 2022
status Planning
scale 1:500 @ A3
drawn NG checked BM
job no. 2783 dwg no. P404 rev.